

A- Changing The Door Swing Direction to Right Hand

1- Lie down the appliance to the left side. (FIG-1)

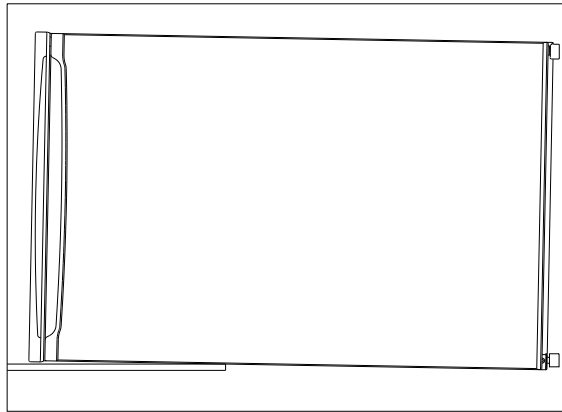

Figure - 1

2- Dismantle both leveling foot. (FIG-2.1)

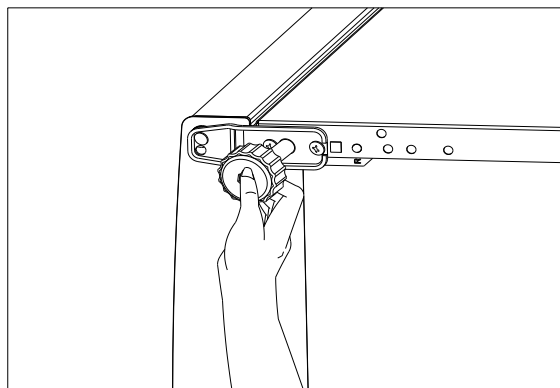

Figure - 2.1

Unscrew the bottom hinge fixing screws and remove it. (FIG-2.2)

Unscrew the bottom hinge pin and screw in the next hole. (FIG-2.3)

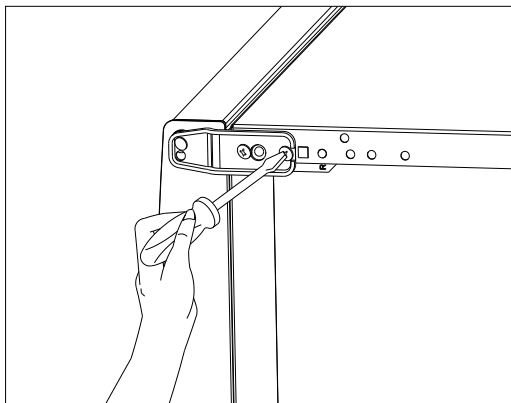

Figure - 2.2

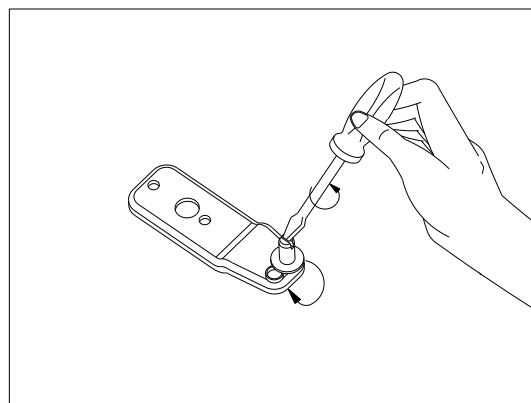

Figure - 2.3

MARCH 2016

3- Remove the door. (FIG-3)

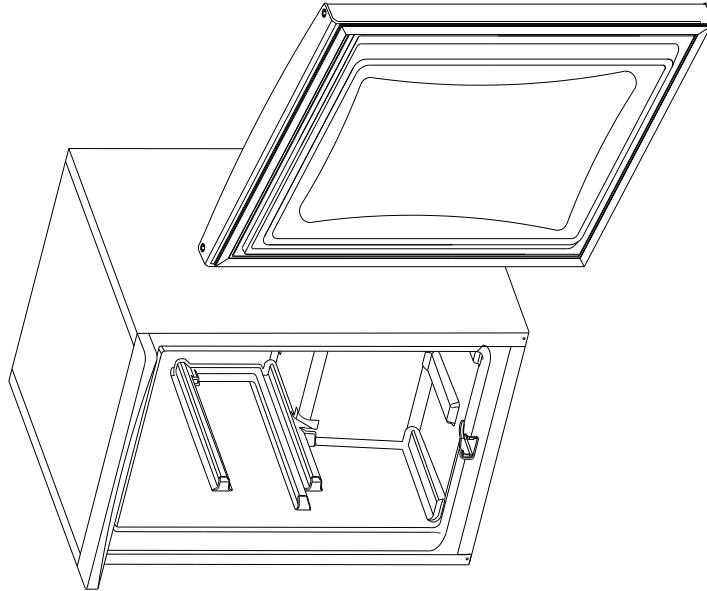

Figure - 3

4 - Unscrew the right pin of the top hinge (FIG-4.1) Screw the pin on the left hole of the top hinge (FIG-4.2)

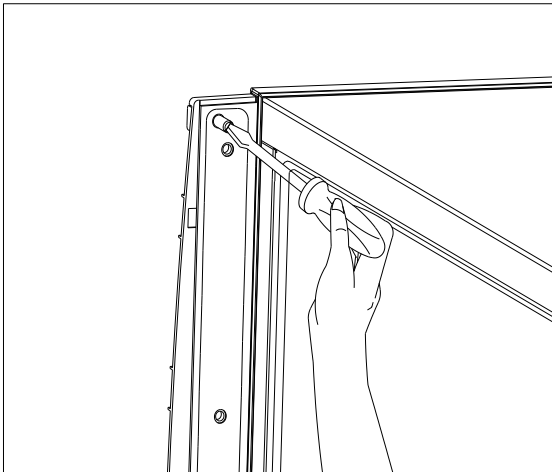

Figure - 4.1

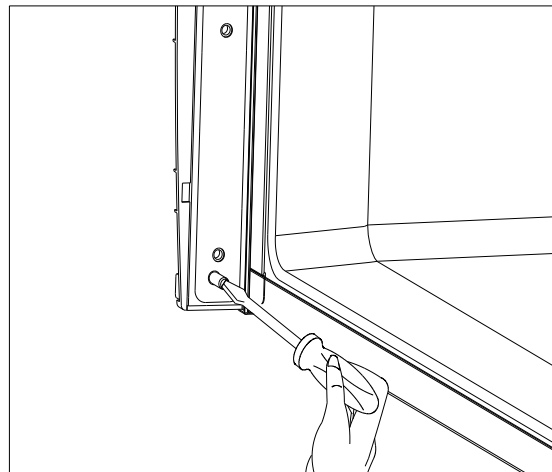

Figure - 4.2

5- Replace the top bushing and top bushing cap. (FIG-5)
 (You can use the bushing cap that is put in the user manuel bag)
 Remove the bottom bushing and assemble it to the left side. (FIG-5)

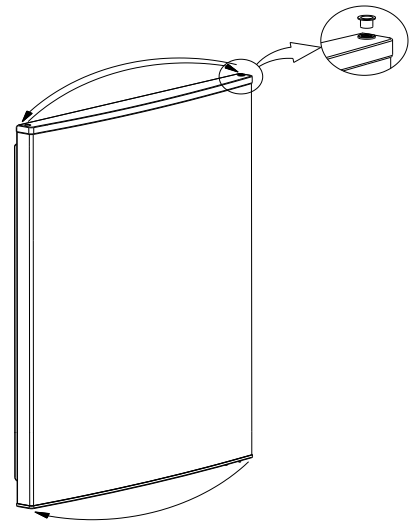

Figure - 5

6- Assemble the door to the top hinge. (Reverse operation of item 3)

7- Screw the bottom hinge to the left side of the refrigerator and screw the both leveling feet.

B - Thermostat Knob

The freezer thermostat automatically regulates the inside temperature of the compartments. By rotating the knob from position 1 to 3, colder temperatures can be obtained. “•” position shows thermostat is closed and no cooling will be available.

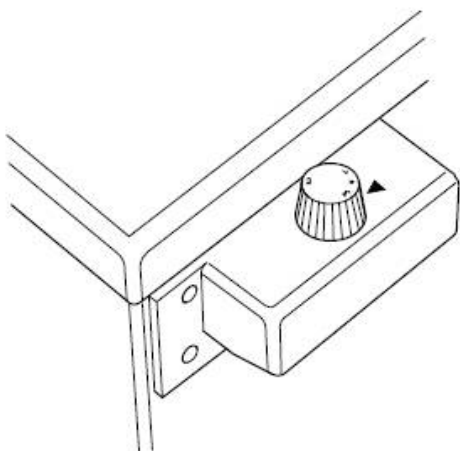

Freezer Thermostat Setting;

- : The appliance is closed
- 1 : For short-term storage of food in the freezer compartment, you can set the knob between minimum and medium position.
- 2 : For long-term storage of food in the freezer compartment, you can set knob to medium position.
- 3 : Max. cooling position. The appliance will work longer.

Note that; the ambient temperature, temperature of the freshly stored food and how often the door is opened, affects the temperature in the freezer compartment. If required, change the temperature setting.

REFRIGERANT CYCLE DIAGRAM

