

Lighting (If available)

When the product is plugged in for the first time, the interior lights may turn on 1 minute late due to opening tests.

Temperature Set Button

This button allows setting temperature of the fridge. In order to set values for fridge partition, press this button.

Temperature Settings

- Every time you press the button, the setting temperature will decrease.
- Settings display and you do not press any button within the following 3 seconds.

Super Freeze Mode

When would it be used?

- To freeze huge quantities of food.
- To freeze fast food.
- To freeze food quickly.
- To store seasonal food for a long time.

If refrigerator is cooler

Super Cooling Mode

When would it be used?

- To cooling huge quantities of food.
- To cooling fast food.
- To cooling food quickly.
- To store seasonal food for a long time.

How to use?

- Hold down temperature set button for 5 seconds to activate super mode when set is MAX.
- All lights will be lighted constantly.

During this mode:

If you hold down set button for 5 seconds, super mode will be deactivated. The super mode will be cancel automatically after max 48 hours.



379 – 389 ELID



Display and Control Panel

Door Open Alarm Function

If cooler door is opened more than 2 minutes, appliance will give sound warning.

Stand-By Mode

Select min set value

Press the set button for 5 seconds.

All components will be off.(include lighting)

When mode activated, all leds will blink three times and turn off.

If the mode is active when the set key is pressed for less than 5 seconds, all leds will blink 3 times.

For cancel this mode, press the set button for 5 seconds.

Demo Mode

This mode can be used to show functions & modes to customer or end-user without operating cooling components such as a compressor, fan etc.

While in the mode, you can do all the operations on the display as if the product is working. This includes all temperature settings and entry-exit operations for special modes such as holiday and economy mode. Interior lighting will continue to function in normal operation. Parts that provide only cooling functions will not operate.

Entering Demo mode:

Plug the product in.

First select the "4" set value, after that push set button 5 seconds.

Procedure must be completed within first 1 minute

All components will be off except interior lighting and set value leds.

Set leds will light sequentially every 1 seconds.

Example; set_1 led light, after 1 second set_1 led light off set_2 led light on...

When appliance is in Demo mode; if plug is removed or there is an electricity breakdown; demo mode will continue with current settings after user plug into or electricity breakdown finish.

Canceling Demo mode:

Push set button 5 seconds.

There is no automatic exit for demo mode.

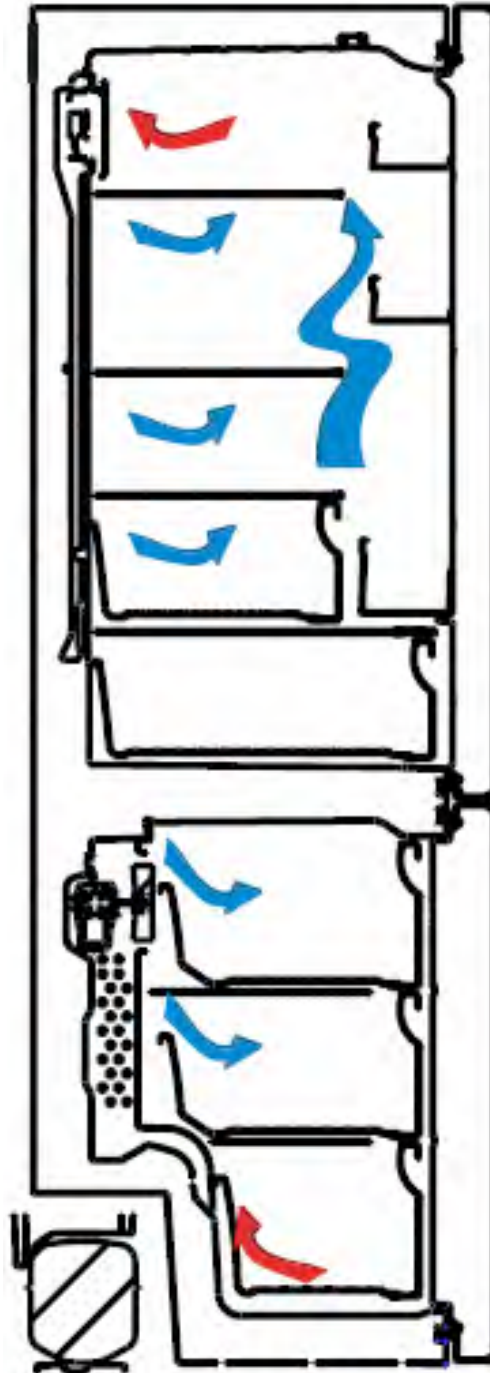

Cutaway view: Air Flow Direction

-  **Blown : Cold Air**
-  **Returned: Hot Air**

Air Flow Diagram

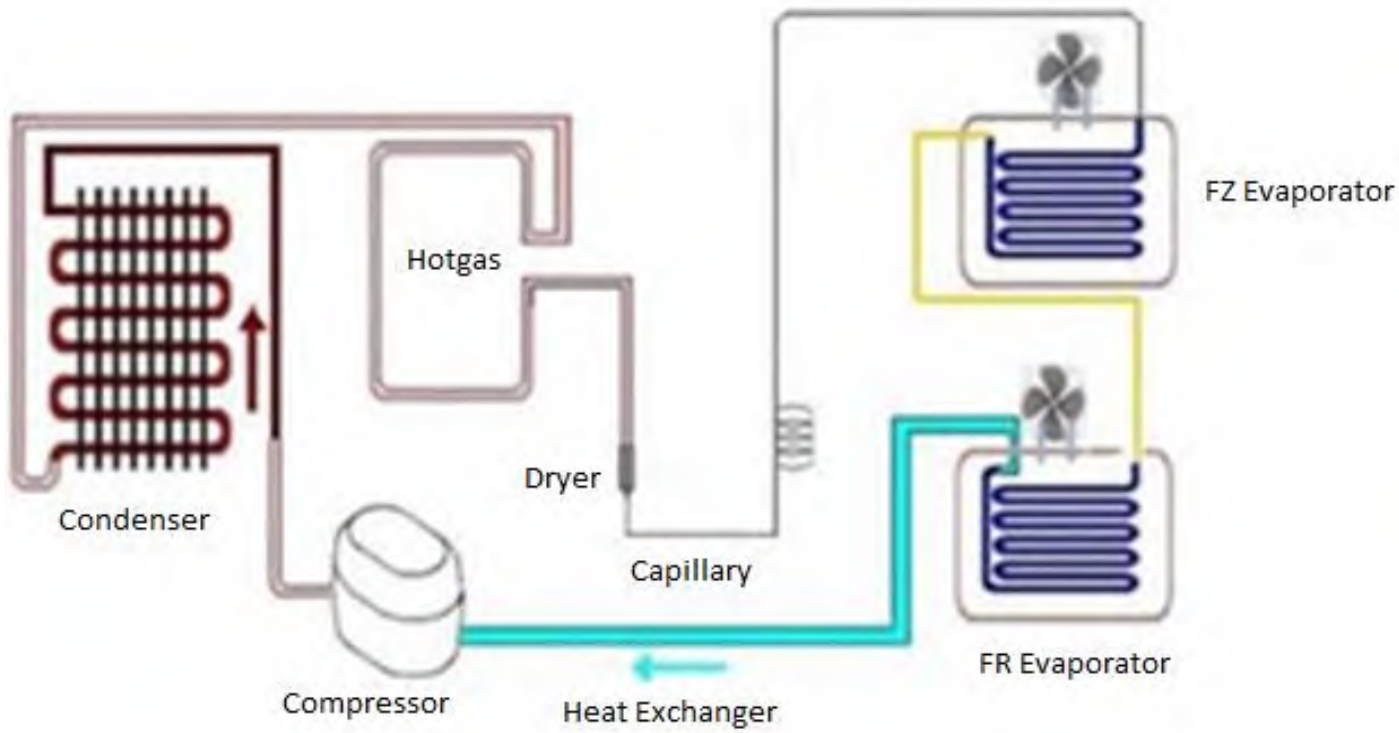

Cooler and defrost sensors are interchangeable.



RDS and AT sensors which located at the foamed body, are not accessible components.

FR Evaporator Sensor (RDS)

Ambient Temperature Sensor (AT) If available



Changing The Door Swing Direction to Right Hand

Hold the top hinge cover and remove it toward that direction.

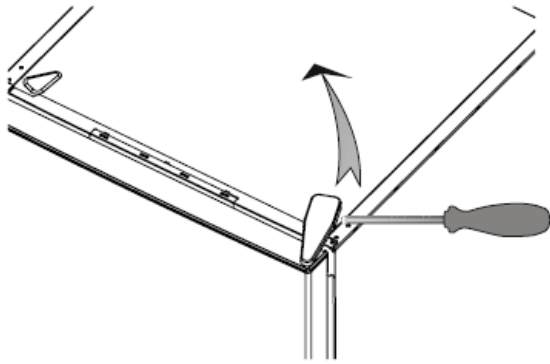

Unscrew the screws fixing the top hinge and remove it.

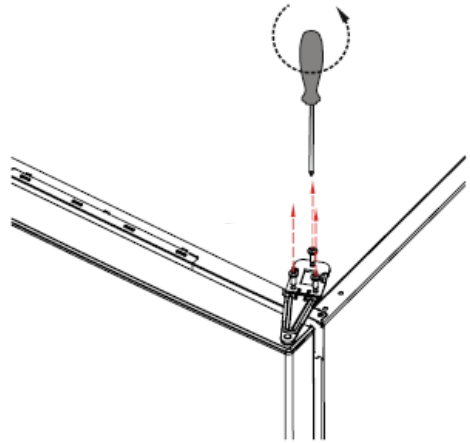

Displace the top door.

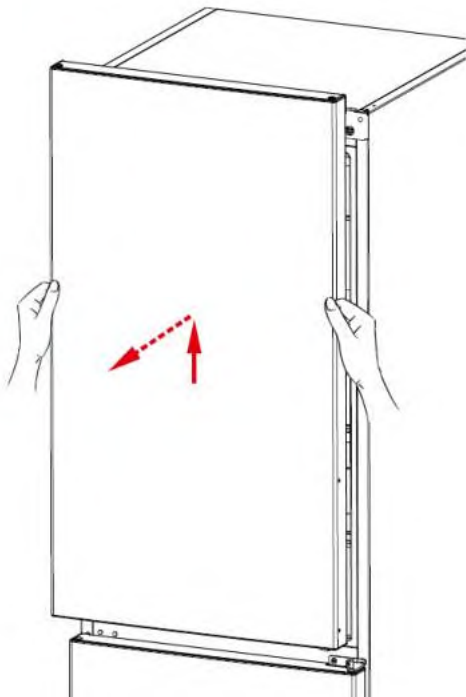

Remove the hinge cover cap and assembly right side.

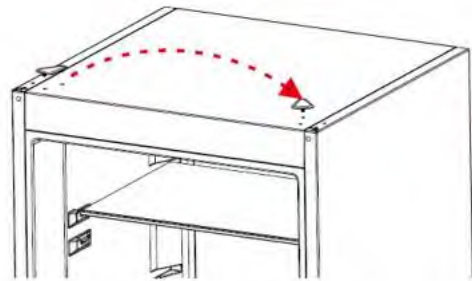

Unscrew the two screws fixing the middle hinge and remove it.

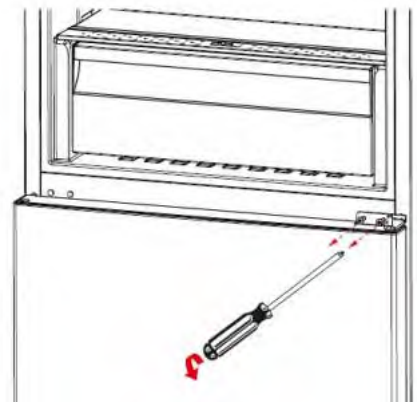

Changing The Door Swing Direction to Right Hand

Displace the bottom door.

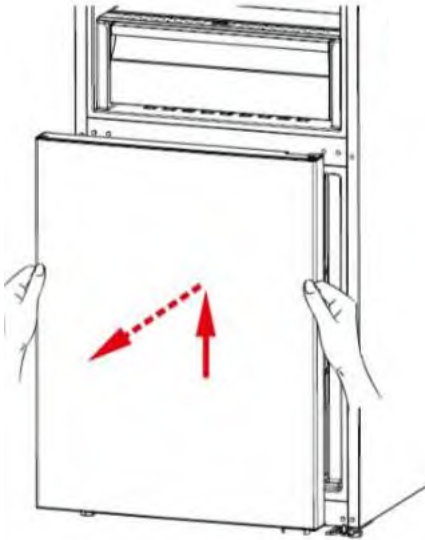

Unscrew the bottom hinge screws.
Unscrew the adjustable foot.

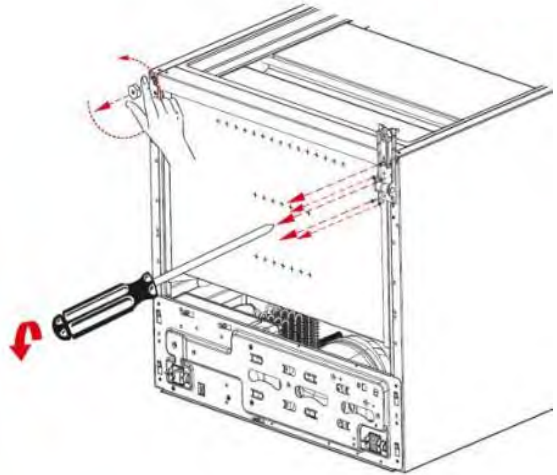

Unscrew the bottom hinge pin and
screw it to other hole.

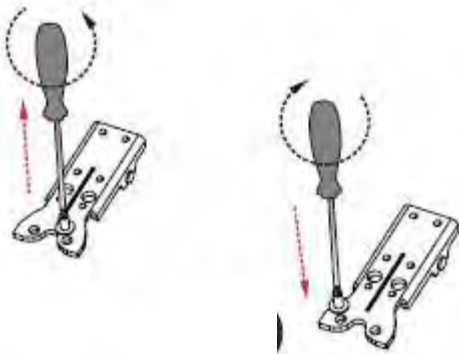

Screw the bottom hinge to the left bottom
side of refrigerator. Screw the adjustable
foot there.

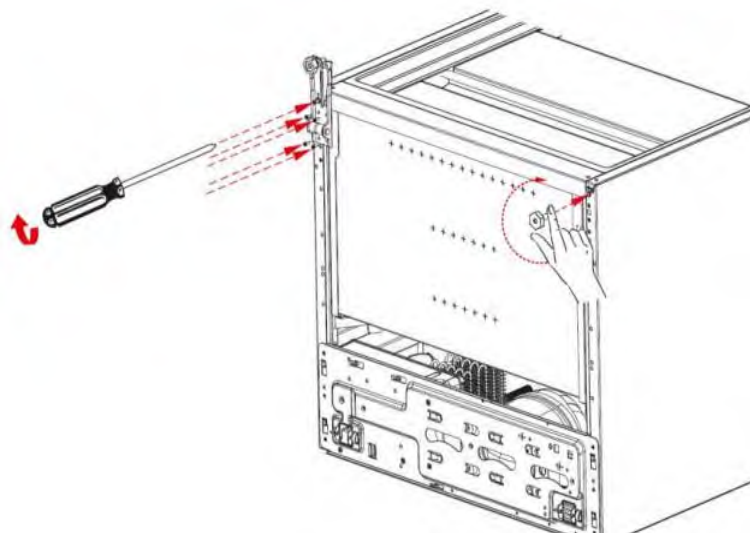

Changing The Door Swing Direction to Right Hand

Replace the top bushing and the top bushing cap at the bottom door.

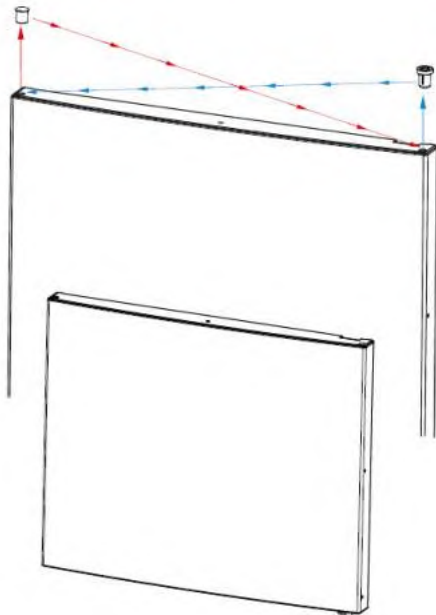

Unscrew the two screws fixing stopper and stopper support plate under the bottom door. After that screw the other side.

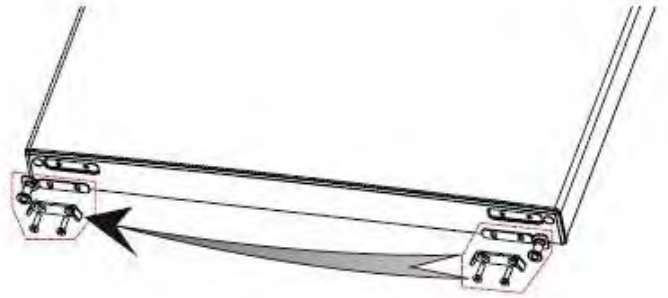

Remove the support plastic and then metal stopper placed under the upper door. Then re screw these parts to the other side symmetrically.

(remember the screw for the metal part must be screwed to the hole which is closer to the bushing). Do not use cordless screwdriver for these screws.

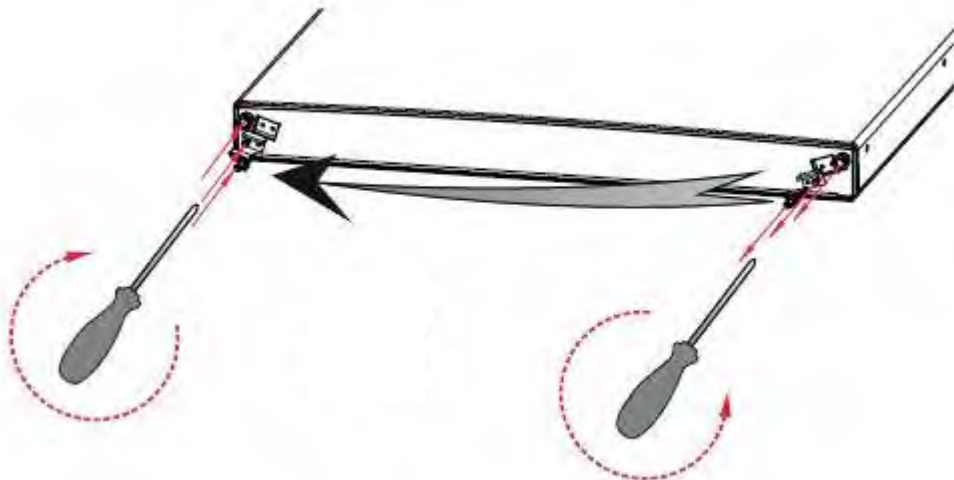

Changing The Door Swing Direction to Right Hand

Remove the middle hinge cover and then screw the screw on the side panel and assemble to the right side panel

Place the bottom door and rotate the middle hinge by 180°. After that, screw to the right side on the middle sheet.

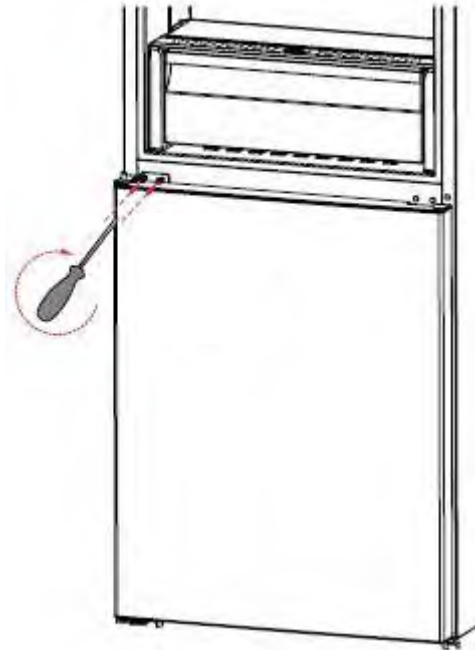
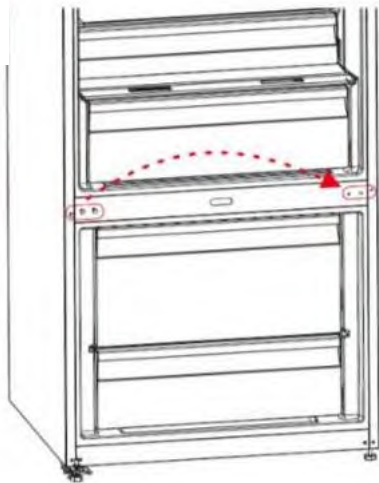

Place the top door to the middle hinge and then connect the display connector and screw the top hinge to the top panel. Place the top hinge cover.

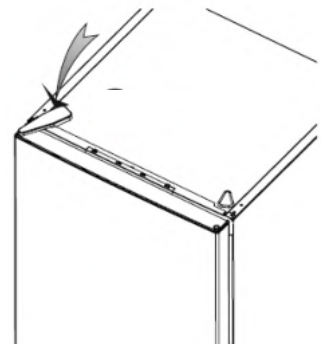
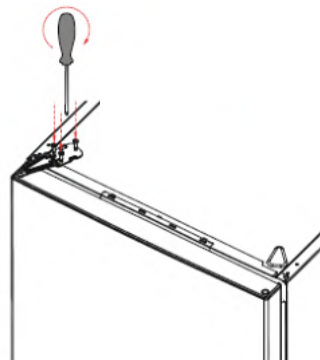
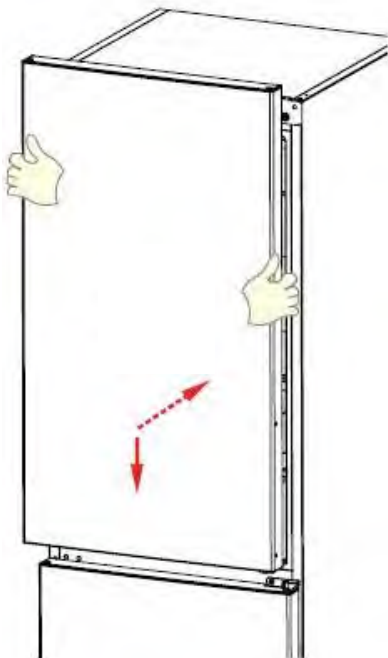

Removing The Thermostat Box Gr

Unscrew the screw fixing the thermostat box.

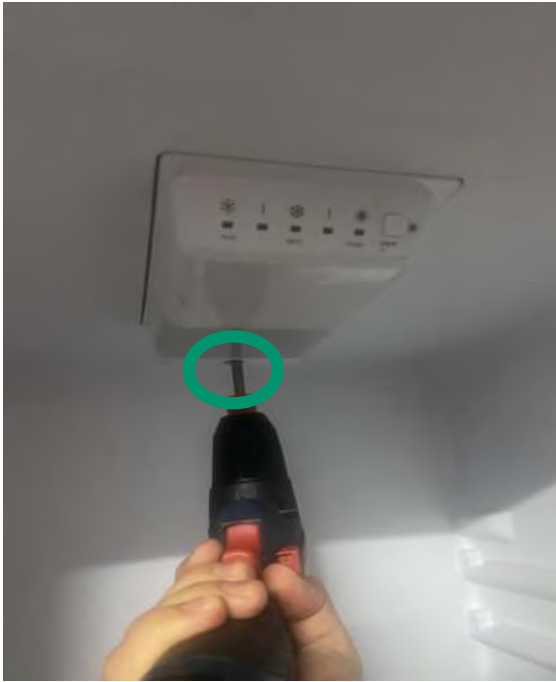

Disconnect the connector after removing it.



Removing The Cooler Multi Flow

Remove the cooler glass shelves and the chiller.



Remove the screw caps by using a flat screwdriver and screw the screws.

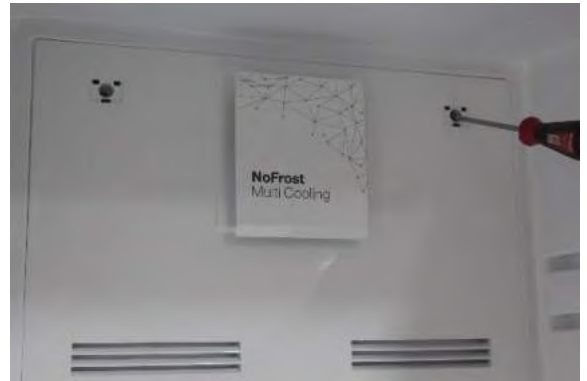

Flex the multi flow by holding the fan cover and remove it.

Note: Please remove the multi flow slowly. Fan cable can get damaged.

Disconnect the connector after removing the multi flow.



Removing The Cooler Multi Flow Fan Motor

Remove the fan cover by flexing the fan cover detail and then remove the fan motor by flexing the fan motor rubbers. (Pic-1/ Pic-2/Pic-3)



Place the rubbers to the fan motor. After that, first place the bottom two details of the fan motor and place the top two details by pressing-flexing it. (Pic-4/ Pic-5/Pic-6)

Note : The fan motor cable outlet should be at the top-left corner of it.

After the connector is connected, place it by flexing it and then reassemble the multi flow by screwing.



Replacement of Refrigerator & Freezer Sensor

Remove the sensor cover by pulling forward and disconnect sensor connector.

Refrigerator Sensor



Removing Freezer Sensor

Remove the sensor cover with the help of a screwdriver and then disconnect the sensor connector.



Removing The Freezer Multi Flow Group

- Displace the glass shelves and baskets if there is.
- Unscrew the screw fixing the multiflow group.
- Removing the freezer bottom cover by flexing back side of it.
- Remove the fan motor connector.



Removing Fin Evaporator Group

1. Remove the fin evaporator resistance connectors from the sockets. (Pic-1) (blue connector)

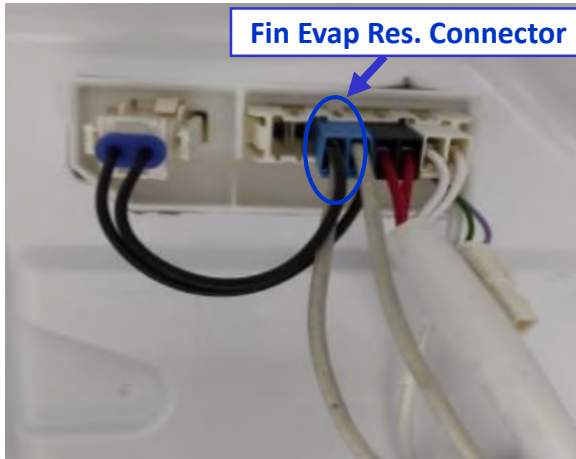

Picture-1

2. Displace the fin evaporator balanced by holding on both sides. (Pic-2)



Picture-2

CAUTION: The fin evaporator should not be pulled upward-downward. Otherwise, the fin evaporator fixing plastics might be broken.

Removing The Thermal Fuse

1. Remove the thermal fuse connector. (Pic-1) (black-white connector)

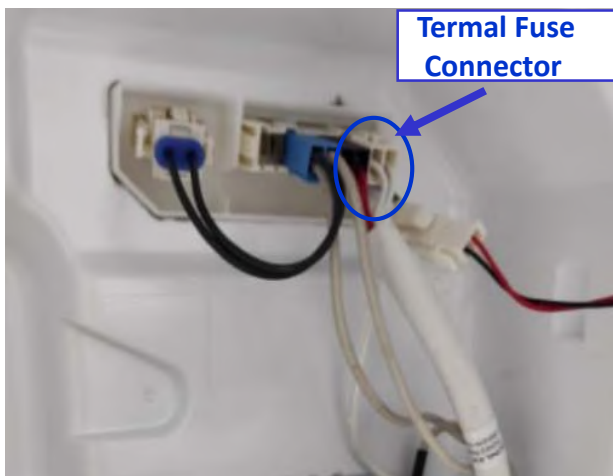

Picture-1

2. Thermal fuse has two details. These details hold on to the pipe. It could be removed easily.(Pic-2)



Picture-2

Removing The Freezer Fan Motor (Radyal)

Unscrew the air multiflow plastic.

When removing the air duct plastic, pay attention to the connection of the fan socket cable.

Remove the fan motor connector. (White socket on the left)



Unscrew the fan cover plastic on the fan motor.

Unscrew the fan motor fixing screws and displace the fan motor.

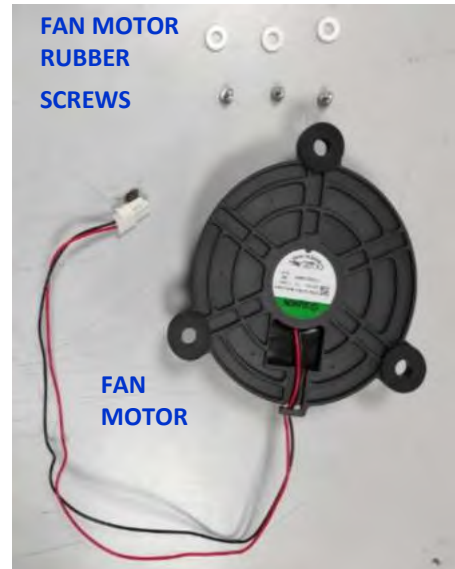

Combi Bottom Radial Fan

Voltage	12.0 V
Power	0.78 W

Cabinet Freezer Radial

Voltage	12.0 V
Power	1.8 W

Cabinet Fridge Radial

Voltage	12.0 V
Power	0.72 W

Removing Fin Evaporator Sensor

Displace the defrost sensor from its location. Cut the end of the sensor cable by using pliers/side cutting pliers.

Connect the cut sensor cable ends to each other as separate clips.

Immobilize the sensor resistance's end its previous position by using cable bant.

In order to prevent oxidation on the metal end of clips. You can use paste which is founded in kit.

Excessive part of the cable should not be left scattered in order not entanglement on the fan motor. It should be fixed with a separate cable bant.



32030727 - SENSOR SERVICE KIT

Removing/Assembling The Door Switch

1. Stick a tape to protect the body plastic. Flex it with the help of a tool like a slotted screwdriver. (Pic-1)



Picture-1

2. Also flex the top-side of the switch and then displace by pulling. (Pic-2)



Picture-2

3. Put the switch connector cable in the housing. First place the top-side of the switch and then push the bottom side.(Pic-3.1/Pic-3.2)



Picture-3.1



Picture-3.2

4. After the switch is placed, complete the assembly by pushing. (Pic-4)



Picture-4.1

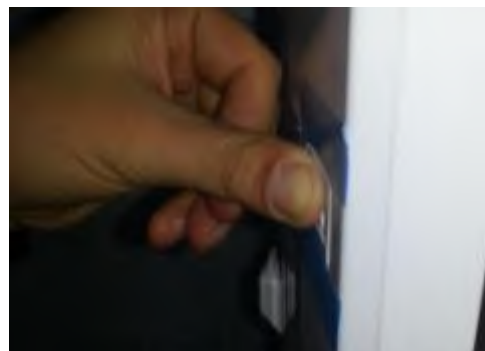

Picture-4.2

CAUTION: The bottom-top details of the switch are different from each other to avoid assembling wrong!

Removing- Assembling The Door Gasket

Pull the gasket towards starting from top right corner
 Slowly pull the rest of the gasket.
 Completely remove the gaskets from bottom and upper doors.

Check the replacement gasket form
 Starting with upper right corner, press on the gasket until it fits to its place..
 Place the other sides of the gasket with the help of your thumb

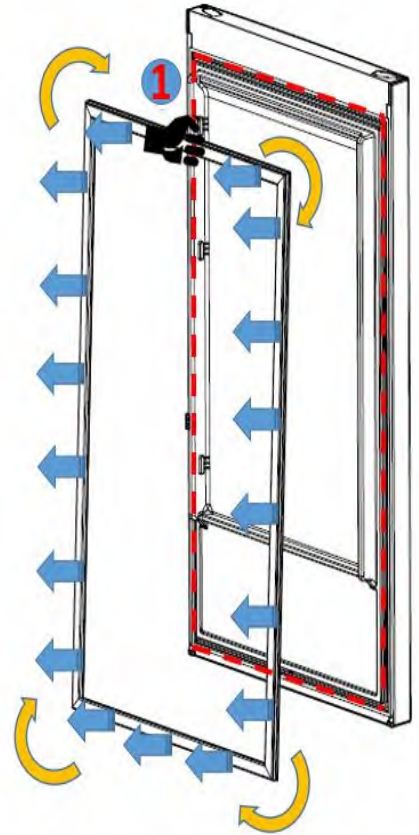
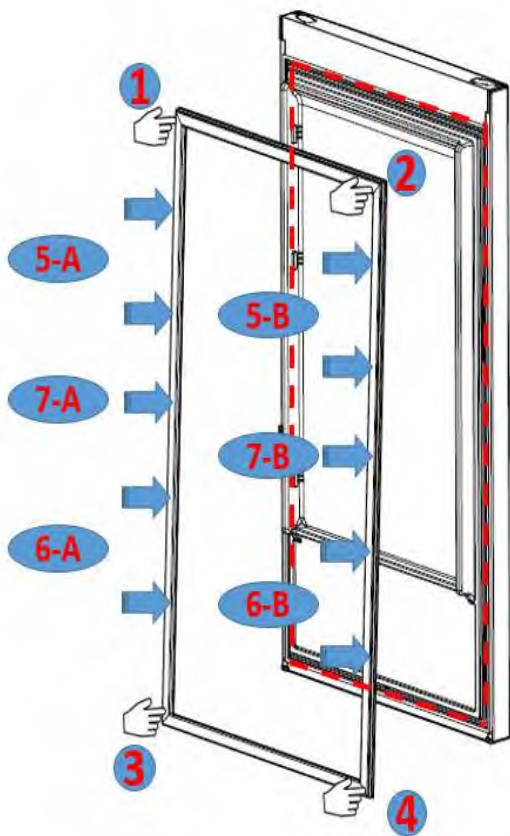

Please follow below order for pulling the gasket out to remove it properly

1 → 2 → 3 → 4 → 5A → 5B → 6A → 6B



379 – 389 ELID



Barcode and Serial Number Explanation:

Vestel refrigerator serial numbers are consist of 22 digits.

